

March 3, 2026

Press release

Mitsubishi Estate Co., Ltd.
 Kanematsu Corporation
 SkyDrive Inc.

Tokyo Metropolitan Government's Project to Develop Business Models for eVTOL Services
Japan's First eVTOL Demonstration Program Simulating Real-world Operations
 — Advancing Public Deployment Through Automation and Optimization of Vertiport Operations —

As part of the “Project to Develop Business Models for eVTOL Services” a project announced by the Tokyo Metropolitan Government in June 2025, Mitsubishi Estate Co., Ltd., Kanematsu Corporation, and SkyDrive Inc. conducted five days of eVTOL flight demonstrations under real-world operational conditions, at Tokyo Big Sight’s East Parking Area from February 24 to 28, 2026.

The goal of this demonstration flight program was to identify the operational challenges toward social implementation of eVTOL. It marked the first-ever demonstration in Japan*¹ to verify eVTOL flight operations and passenger terminal operations using a Vertiport Automation System*².

※1 According to research conducted by the three companies

※2 Vertiport Automation System (VAS):

A VAS is a system for automating and optimizing vertiport operations. It supports safe, secure, and frequent flight operations by monitoring vertiport availability and the surrounding airspace, as well as digitally managing vertiport resources including ground facilities, while also installing equipment necessary to enable seamless passenger check-in and flow management.

To verify the effectiveness of terminal operations, members of the public were invited to experience the pre-boarding procedures, including facial recognition check-in and security screening. Their feedback will help identify challenges related to usability and operations for future social implementation. In the remotely piloted flight demonstration, a domestically developed aircraft was used in Tokyo for the first time.

During the demonstration period, observation events open to the public were also held to promote public understanding and acceptance of next-generation mobility. Over 1,500 visitors, including stakeholders, observed eVTOL aircraft takeoff and landing operations as well as the operational control facilities, such as the terminal.

The three companies will further advance efforts toward social implementation and commercialization of eVTOL-based services.



▲ Demonstration flight



▲ Terminal operation demonstration



▲Media day on February 24



▲Stakeholders and the Vice Governor ※3

※3 From left :

Hiroshi Shioiri, General manager, Marunouchi property business planning department, Mitsubishi Estate Co., Ltd.

Katsumi Takano, Director general, Bureau of digital services, Tokyo Metropolitan Government

Matsumoto Akiko, Vice governor of Tokyo

Hiroki Masuko, Chairman of the Tokyo Metropolitan Assembly

Tomoka Okubo, Mayor of Koto City

Koichi Kanno, Vice Chairman the Tokyo Metropolitan Assembly

Manabu Miyasaka, Vice governor of Tokyo

Tomohiro Fukuzawa, CEO & Founder, SkyDrive Inc.

Ryoichi Kidokoro, Managing Executive Officer, Kanematsu Corporation

Duncan Walker, CEO & Founder, Skyports Limited.

■ SkyDrive eVTOL Demonstration Flight Video

<https://youtu.be/II0tTF3c9Ak>



■ Details of the Demonstration Program

1. Demonstration of eVTOL passenger terminal operations < terminal demonstration >

A VAS-equipped passenger terminal was prepared with the cooperation of Skyports, a UK company that builds and operates vertiports globally. The participants experienced terminal facilities such as the facial recognition check-in, security screenings, safety video viewing, and a boarding gate. The feedback obtained through the program will be used to refine future services and operations.

<Overview of the Terminal >

Terminal Concept	Movable terminal using trailer units
Total Floor Area	Approx. 54 m ² (Two trailer houses of 17.06 m ² each + deck space of approx. 20 m ²)
Basic Design	Mitsubishi Jisho Design Inc.
Construction	YADOKARI Inc.
Functions	<ul style="list-style-type: none"> • “Gallery” features an informational display on eVTOL. • “Deck” is a viewing area designed to build passenger excitement. • “Security check area” equipped with an automatic facial recognition check-in and security screening to conduct a simple and seamless pre-boarding process. • “Lounge” is a comfortable space for passengers to wait for their flight while checking the latest flight information and other updates on the monitor • “Operations room” performs centralized management to ensure safe and efficient vertiport operations, including the following operational support tasks: overseeing the availability of FATO, STAND area, and other vertiport facilities; monitoring the surrounding airspace (information on local weather and air traffic conditions); and managing passenger check-in and other boarding procedures.

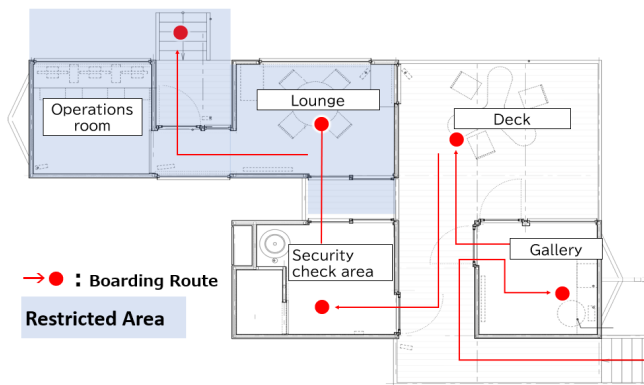

▲Terminal floor plan



▲Exterior view of the terminal

2. Demonstration of eVTOL operations through demo flights and verification of airspace monitoring system

Demo flights were conducted using “SKYDRIVE”, an eVTOL aircraft developed by SkyDrive—simulating unmanned operations under automatic control and remote piloting. It also involved a demonstration for visualizing flight paths by importing flight information into an airspace monitoring system*4.

※4 A system for monitoring air traffic, including airplanes and helicopters, in the surrounding airspace.

< Overview of the Demonstration Flight > First Flight on Tuesday, February 24, 2026

eVTOL	<p>SkyDrive Model SD-05</p> <p>< Specifications ></p> <ul style="list-style-type: none"> ▪ Three-seater: 1 pilot and 2 passengers ▪ Approx. 11.5 m (L) × 11.3 m (W) × 3 m (H), including rotors ▪ Maximum takeoff weight: 1,400 kg ▪ Propulsion : 12 units of motors and rotors ▪ Power supply: Battery (electric) ▪ Main structural materials: Composite, aluminum alloys, etc. ▪ Maximum cruise speed: 100 km/h (air speed) ▪ Range: 15–40 km
Flight Distance	150m
Flight Time	Approx. 3 minutes 30 seconds
Flight Speed	4m/s
Flight Altitude	13m

■ Roles of Each Company

Mitsubishi Estate Co., Ltd.	<ul style="list-style-type: none"> • Overall project management • Evaluation of implementation in urban areas and buildings based on operational and vertiport requirements • Development of the terminal
Kanematsu Corporation	<ul style="list-style-type: none"> • Provision and structuring vertiport requirements based on overseas regulatory and technological trends, etc. • Study and information provision related to vertiport operations • Demonstration of VAS-equipped terminal operations <p>※ Implemented with the cooperation of Skyports, a business partner</p>
SkyDrive Inc.	<ul style="list-style-type: none"> • Conduct of demonstration flights • Summarizing of vertiport requirements from an operator’s perspective • Evaluation and coordination related to air traffic control and flight operations • Business model development

【Contacts】

- ◆ Corporate Communications, Mitsubishi Estate Co., Ltd. Tel: +81-3-3287-5200
- ◆ PR Section, Kanematsu Corporation Tel:+81-3-6747-5000 [Contact Us](#) | [Kanematsu Corporation](#)
- ◆ PR, SkyDrive Inc. Email : info@skydrive.co.jp <https://skydrive.co.jp/contact>